

**RITE® SERIES 210
SINGLE DOOR WAFER TYPE SWING CHECK VALVE
INTEGRAL SOFT SEAT**



OVERVIEW

The Rite® Series 210 wafer combination swing check valves are flow activated and Rite® Sized. The Rite® Series Check Valve inlet ports and disc have been shape optimized to achieve a fully open position at low flow rates (3 ft/s on average).

SPECIFICATIONS

Size Range	NPS 1" to 60" 25mm to 1500mm
Temperature Range	-240 to 400 °F (-151 to 204 °C) (Pending Materials Selected)
Operating Pressure	ASME (125, 150, 300) DIN (PN10, 16, 25, 40)
Body Style	One-Piece Wafer Body Integral Type
Leakage Rate	Zero Leakage

APPLICATIONS

- > Chemical Processing
- > Electrolysis
- > Facilities/Skid
- > HVAC
- > Marine
- > Nuclear
- > Oil Transport
- > Petrochemical
- > Power Generation
- > Refrigeration
- > Storage & Transport
- > Tank Trucks
- > Water

MEDIA

- > Dry Chlorine (Gas or Liquid)
- > Gases
- > Hydrogen
- > Oxygen
- > Water

DESIGN FEATURES

The Series 210 soft seated check valves offer:

SINGLE DOOR DESIGN:

Below numbered list can be referenced on various figures throughout document

- 1 Combination design utilizing both gravity + spring makes the valve easy to open/close, reducing water hammer.
- 2 Limited movement of internal parts during operation extends service life.
- 3 Elliptical inlet shape designed to accelerate line media through the valve.
- 4 Optimal diameter for high flow capacity.
- 5 Short face to face, reducing weight and space between flanges.
- 6 Low cracking pressure design.
- 7 Quick response time (ideal for process lines with varying flows & control valves).
- 8 Customizable modular design, allows for adding optional special accessories to meet customer application requirements.
- 9 Cost & energy efficiency, requiring only one set of flange studs which span the valve, reducing in-service vibration.
- 10 A mechanically dynamic seal, contained in a specially designed groove.
- 11 Maintenance is simple as the o-ring is easily removed and replaced when worn.
- 12 As pressure is applied to the valve disc, the seal is compressed into the groove ensuring a consistent and uniform seal.
- 13 The load on the seal is controlled, reducing wear for longer life.

Figure 01: Integral Soft Seat Cutaway Front View.

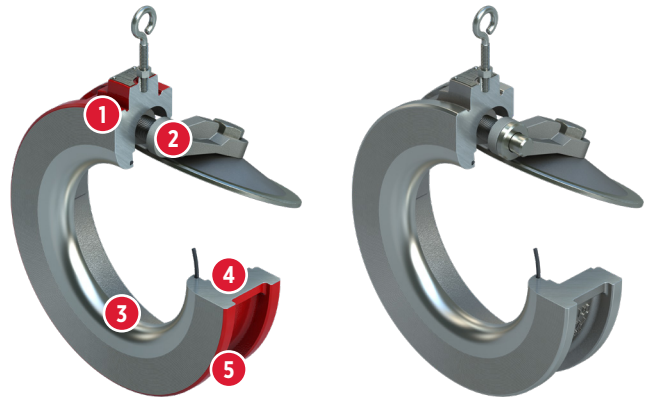

Figure 02: Integral Soft Seat Cutaway Rear View.



RITE® SERIES 210
SINGLE DOOR WAFER TYPE SWING CHECK VALVE
INTEGRAL SOFT SEAT



DESIGN STANDARDS

Valve Design	ASME B16.34
Accessories Available	H100, SA01, SA1, SA2, SA3, SA4, SA4A, SA6, SA7, SA10, SA16, SA40, SA40A, SA50, etc.
Testing Standard	API 598, ASME B16.34
Face-to-Face	Manufacturer's Standard

CERTIFICATIONS AND APPROVALS

Certifications	CE/PED CRN
Approvals	NSF-61

Additional information is available in the Bray Rite® Ltd. Technical Sales Manual.

MATERIAL OPTIONS¹

Body Material determines whether design is integral type, or seat ring type. See below chart:

Body	Cast Iron (ASTM A126 CLB) Stainless Steel (ASTM A351 CF8M) Exotic Alloys
Hinge	Stainless Steel (ASTM A351 CF8M) Matches body material on exotic materials
Seat (Integral)	Matches body material Valve size: ≤12": Stainless Steel (ASTM A313 316) standard duty Valve size: ≥14"+: Stainless Steel (ASTM A313 17-7 PH) Inconel (X750) on exotic body materials
Spring	Inconel (X750) on exotic body materials
Spacer	Stainless Steel (ASTM A479 316), PTFE optional
Pin	Stainless Steel (ASTM A479 316) Matches body material on exotic materials
Plug	Steel Matches body material on stainless steel and exotic alloys
Lock Nut	Steel Zinc Plated
Eye Bolt	Steel Zinc Plated
Nameplate	Stainless Steel (SS 316)
Disc	Stainless Steel (ASTM A351 CF8M) Matches body material on exotic materials
Rivet	Steel Zinc Plated
O-Ring	BUNA-N, EPDM, FKM-A, HNBR, Neoprene PTFE-virgin, Teflon encapsulated silicone, Viton
Disc Nut	Stainless Steel (ASTM F594 316) Matches body on exotic materials

Rite® Series Check Valve integral type part number: V0215CBZ (For 2", Class 150, Cast Iron ASTM A126 CLB Body, BUNA-N Seat, SS Spacer, Series 210)

Note: ¹Dimensions available in ASME and DIN sizes.

Figure 03: Integral Soft Seat Exploded View, Cast Iron.

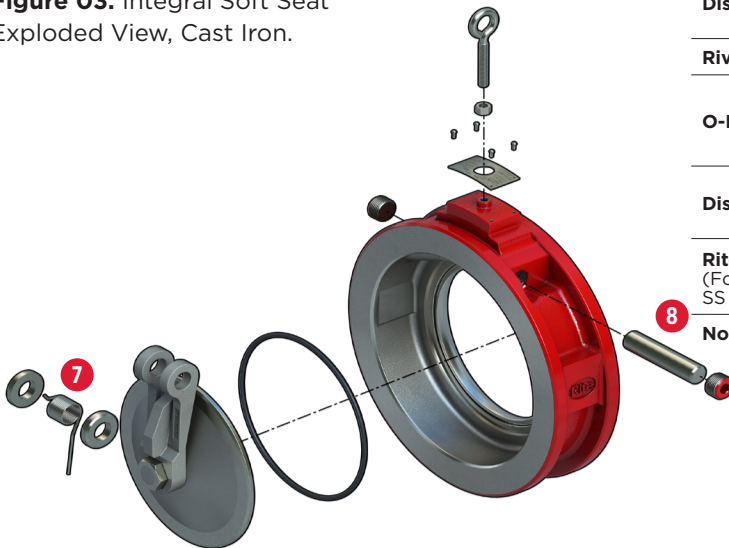

Figure 04: Integral Soft Seat Exploded View, Stainless Steel.



Figure 05: Integral Soft Seat In-Pipe View.

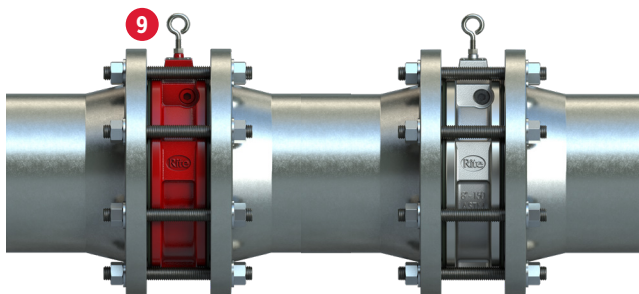

Figure 06: Integral Soft Seat Close-Up Cutaway Views.

